

BELLOWS GATE VALVE 150#/300#/600# ANSI FLANGED/BW



Fig. 2472

Features

Design	ASME B16.34. Bolted bonnet. Metal seated. With bellows
Rating	150# / 300# / 600#
Face to face	ASME B16.10
Ends	ANSI Flanged. BW

Materials

N°	Part name	Material
1	Body	A216 WCB / A351 CF8M
2	Seat	A105 + STL / A182 F316 + STL
3	Wedge	A216 WCB + STL / A351 CF8M + STL
4	Stem	A182 F6A / A182 F316
5	Bellows	AISI 304 / AISI 316
6	Gasket	AISI 304 + Graphite / AISI 316 + Graphite

Main dimensions

Size		L				H			Weight Kg		
		150#		300#	600#	150#	300#	600#	150#	300#	600#
DN	NPS	FL	BW								
50	2"	178	216	216	292	440	450	465	30	35	45
65	2½"	190	241	241	330	520	560	585	50	55	65
80	3"	203	282	282	356	570	590	600	650	70	80
100	4"	229	305	305	432	690	730	750	80	85	95
125	5"	254	381	381	508	810	850	870	95	100	125
150	6"	267	403	403	559	920	960	870	122	125	125
200	8"	292	419	419	660	1200	1250	1270	160	175	185
250	10"	330	457	457	787	1430	1500	1525	260	290	310
300	12"	356	502	502	838	1650	1720	1750	340	365	395
350	14"	381	572	762	889	1920	2010	2140	500	540	575
400	16"	406	610	838	991	2120	2250	2270	610	650	690
450	18"	432	660	914	1092	2450	2620	2650	780	820	850
500	20"	457	711	991	1194	2700	2900	2930	900	930	970
600	24"	508	813	1143	1397	3200	3360	3390	1350	1400	1460

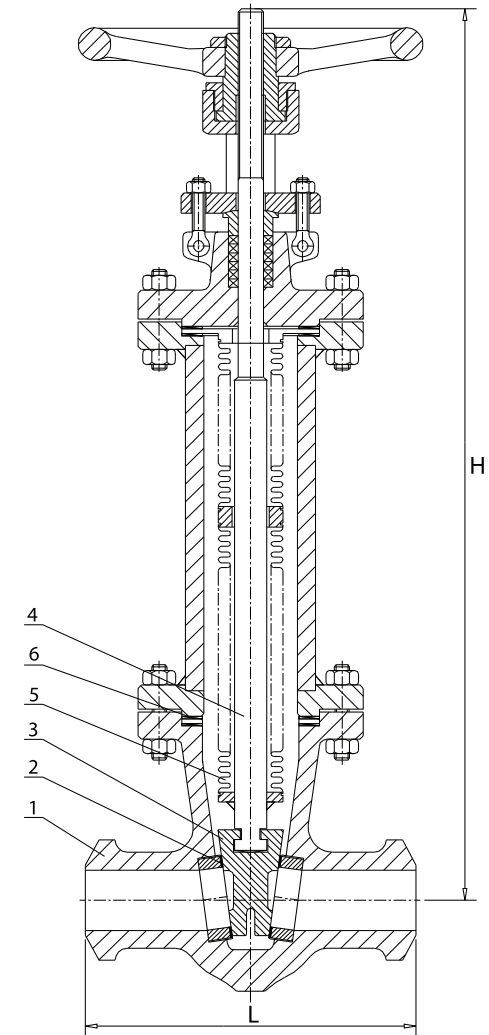

FORGED GATE VALVE BOLTED BONNET 800# NPT THREADED/SW



Fig. 2611

Features

Design	API 602. Bolted bonnet
Rating	800#
Face to face	According to dimension table
Ends	NPT threaded. SW

Materials

N°	Part name	Material
1	Body	A105 / A182 F316
2	Seat	A182 F6A + STL / A182 F316 + STL
3	Wedge	A182 F6A / A182 F316
4	Stem	A182 F6A / A182 F316
5	Gasket	AISI 304 + Graphite / AISI 316 + Graphite

Main dimensions

Size		L	H	Weight Kg
DN	NPS			
15	½"	79	165	2,2
20	¾"	92	169	2,4
25	1"	111	207	4,1
32	1¼"	120	230	5,5
40	1½"	120	249	8,0
50	2"	140	283	10,0

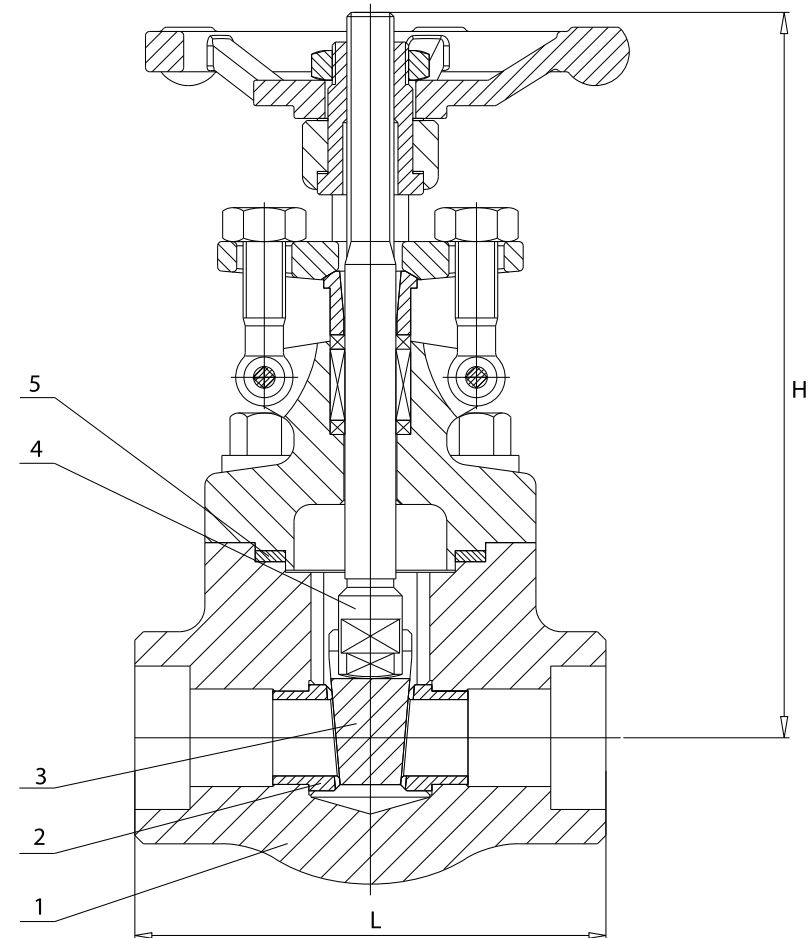

FORGED GATE VALVE PRESSURE SEAL 1500# / 2500# SW



Fig. 2671

Features

Design	ASME B16.34. Pressure seal bonnet
Rating	1500# / 2500#
Face to face	According to dimension table
Ends	SW / NPT / BW

Materials

N°	Part name	Material
1	Body	A105 / A182 F316
2	Wedge	A182 F6A+STL / A182 F316+STL
3	Stem	A182 F6A / A182 F316
4	Gasket	AISI 304 / AISI 316

Main dimensions

Size		L		H		Weight Kg	
DN	NPS	1500#	2500#	1500#	2500#	1500#	2500#
10	3/8"	140	186	318	325	11,5	12,3
15	1/2"	140	186	318	325	11,5	12,3
20	3/4"	140	186	318	325	10,8	11,6
25	1"	140	186	322	327	10,5	10,8
32	1 1/4"	178	232	467	467	19,6	26,0
40	1 1/2"	178	232	468	468	21,0	28,4
50	2"	216	276	540	540	55,4	60,0

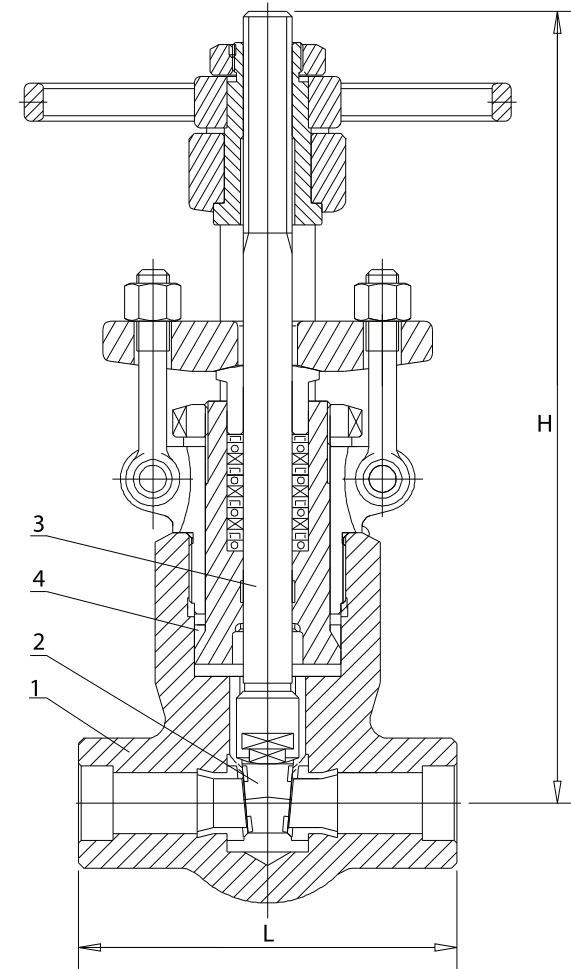

FORGED GATE VALVE BOLTED BONNET 150#/300#/600# FLANGED



Fig. 2612

Features

Design	API 602. ASME B16.34. Bolted bonnet
Rating	150# / 300# / 600#
Face to face	B16.10
Ends	Flanged

Materials

N°	Part name	Material
1	Body	A105 / A182 F316
2	Wedge	A182 F6A + STL / A182 F316 + STL
3	Stem	A182 F6A / F182 F316
4	Gasket	AISI 304 + Graphite / AISI 316 + Graphite

Main dimensions

Size		L			H		Weight Kg		
DN	NPS	150#	300#	600#	150#	300# / 600#	150#	300#	600#
15	½"	108	140	165	176	161	3,40	3,77	4,20
20	¾"	117	152	190	184	163	3,98	4,89	5,80
25	1"	127	165	216	217	196	6,13	7,23	8,80
32	1¼"	140	178	229	226	226	7,20	9,60	12,10
40	1½"	165	190	241	250	250	10,40	12,64	15,60
50	2"	178	216	292	290	290	15,50	18,00	19,50

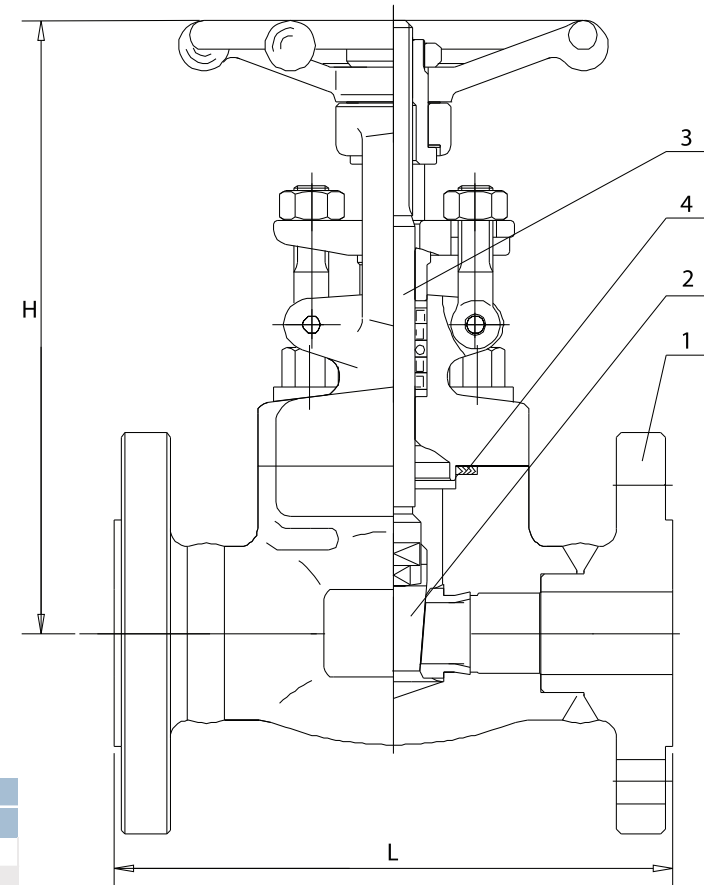

FORGED BELLOWS GATE VALVE BOLTED BONNET 800# NPT THREADED/SW



Fig. 2672

Features

Design	API 602. Bolted bonnet
Rating	800#
Face to face	According to dimension table
Ends	NPT Threaded. SW

Materials

N°	Part name	Material
1	Body	A105 / A182 F316
2	Wedge	A182 F6A + STL / A182 F316 + STL
3	Stem	A182 F6A / A182 F316
4	Bellows	AISI 304 / AISI 316

Main dimensions

Size		L	H	Weight Kg
DN	NPS			
15	½"	79	220	3.0
20	¾"	92	225	4.8
25	1"	111	244	7.9
32	1¼"	120	321	11.0
40	1½"	152	321	16.8
50	2"	172	347	25.2

